



OPTIMIX

2G 55-90

2G 90-90

Application

Submersible motor
 Dry matter content up to 12 %
 Substrate temperatures up to 131 F
 pH-value 6.5 - 8.2

Motor

Motor: 7.5 / 12 hp, 60Hz
 Protection class IP 68, up to 33 ft submergence
 PTC thermistors for thermal protection
 High efficiency
 Own oil circulation, turbine oil

Gear / Bearing

Robust, two stage planetary gear
 Reduction ration $i = 19.6$
 Mechanical seal SiC/SiC
 2 tapered-roller bearings to absorb the axial forces
 Hardened steel spline shaft $\varnothing 1.97$ in
 Separate oil fill with long life gear oil
 Oil change interval 12,000 operation hours

Ex-zone

Authorized for Ex-Zone 2

Propeller

3-blade high efficiency propeller, dynamically balanced

Optimix 2G 55-90	7.5 hp	LT 1000	90 rpm
Optimix 2G 90-90	12 hp	LT 1400-G6	90 rpm

Painted or hardened steel

Guiding unit

Guide mast support with 4 rollers for smooth height adjustment
 Depending version, available for 3.9 / 4.7 / 5.9 in square mast
 Special sizes on request

Corrosion protection

Ductile cast iron housing (GGG40)
 Agitator has a two component epoxy coating
 Agitator is galvanically isolated from the guide mast

Electric Cable

Pressed-on cable gland
 Standard length 33 ft
 Cable $7 \times 4 + 4 \times 1,5 \text{ mm}^2$, $\varnothing 0.8$ in
 Microbe resistant
 Strain relief 180 lbf

Controls

Soft start or frequency converter

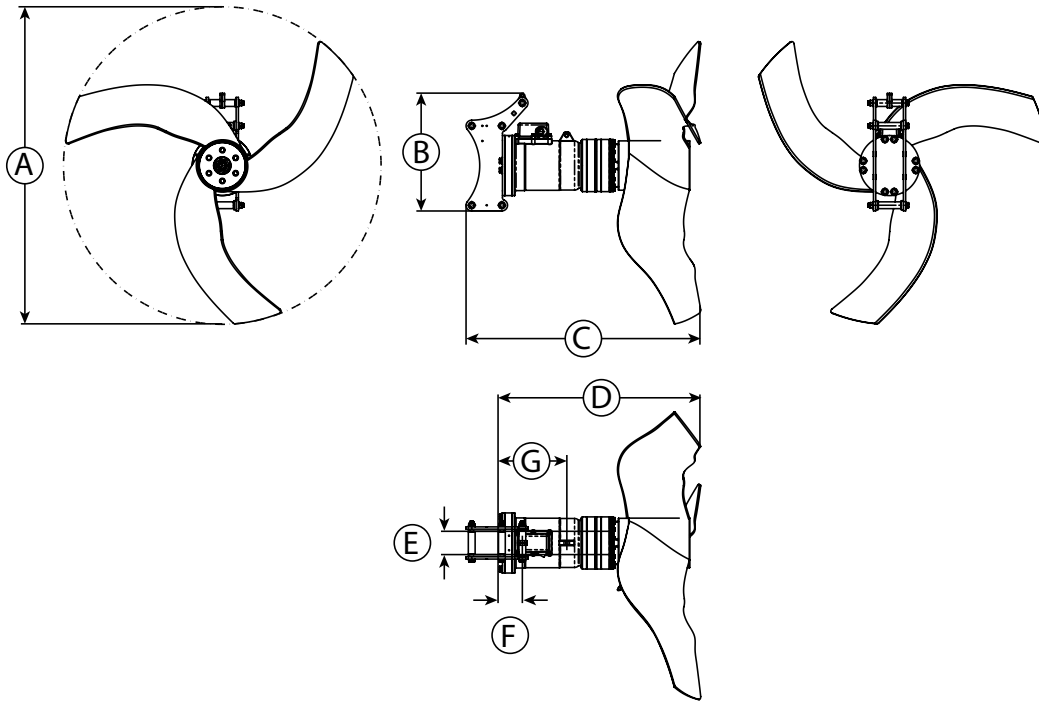

OPTIMIX
2G 55-90
2G 90-90

Dimensions

Type	A Ø [in]	B [in]	C [in]	D [in]	E [in]	F [in]	G [in]				
2G 55-90	39.4 / 55.2	20.5	47	39	3.9 / 4.7 / 5.9	4.1	11.8				
2G 90-90											

Technical data

Type	Rated Power [hp]	Frequency [Hz]	Gear reduction ratio	Propeller speed [rpm]	Propeller diameter [in]	Axial force [lbf]	Flow velocity [ft/s] *	Pumping rate [gal/min]	Weight approx. [lbs]			
2G 55-90	7.5	60	19.6	90	39.4				440			
2G 90-90	12	60	19.6	90	55.2	809	7.2	52,306	440			

Subject to technical changes
 * measured in water and 3.94 ft distance
 As per: 2023-08

© SUMA America Inc. | 2700 Patriot Blvd Suite 400 | Glenview, IL 60026
 Phone: 312.912.1961 | Email: sales@gosuma.com | www.gosuma.com