

## GIANTMIX FR SP

**FR1 75-240**

**FR3 110-330**

**FR4 150-330**

**FR4 150-480**

**FR5 185-480**

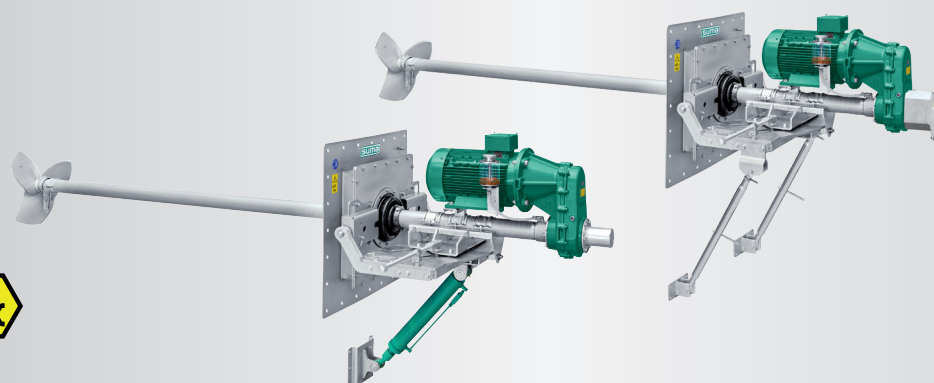

### Application

Long-axis agitator  
 Dry matter content up to 14 %  
 Substrate temperature up to 70°C  
 pH-values 6.5 - 8.2

### Technical Data

Tube length 9.8 / 13.1 ft  
 Agitator shaft Ø 4 x 0.16 in (max. 9.8 ft)  
 or x 0.23 in in ss304 - ss316 version on request  
 Sealing plate/-frame 38.6x38.6/47.3x47.2/56.3x56.3 in ss304,  
 ss316 on request  
 Sound pressure 75 dB(A)  
 Sealing membranes of EPDM60  
 Installation up to 26.2 ft beneath substrate level,  
 deeper immersion depths on request  
 As standard with upper link  
 Oil equalizing container for monitoring the tightness  
 Optional PTO with protection for an alternative tractor opera-  
 tion (max. HD+ 700)  
 Agitator completely manufactured in modular design  
Accessory: POM protection to minimize abrasion

### Motor

10 hp - 8-poles 15.0 / 20.0 / 25.0 hp : 4-poles (IE3 - motor)  
 PTC thermistors 160°C (overheat protection)  
 Ex-Motor II 3G Ex nA IIA T3 Gc  
 Special design 13.5 kW: II 2G Ex e IIA T3 Gb  
 Optional rain protection hood (ss304)

### Gear

Spur gear drive, helical teeth, low noise level  
 Reduction ratio  $i = 3.69$  or  $5.31$   
 Own oil chamber, gear oil SAE 85W-140 / API GL-5  
 Oil change interval all 2,000 operation hours

### Bearing

2 tapered roller bearings to absorb the axial forces  
 Mechanical seal SiC/SiC independent of rotation direction  
 Interim bearings for the drive shaft (slide bearings)

### Propeller

3-blade high efficiency propeller, dynamically balanced

FR1:	10.0 hp	240 rpm	Propeller HD+ 800
FR3:	15.0 hp	330 rpm	Propeller HD+ 660
FR4:	20.0 hp	330 rpm	Propeller HD+ 750
FR4:	20.0 hp	480 rpm	Propeller HD+ 540
FR5:	25.0 hp	480 rpm	Propeller HD+ 580

Standard is ss304, optional ss316, or hardend steel

### Adjustment range

Horizontal adjustable  $\pm 25^\circ$  through spindle  
 Vertical adjustable through upper link, optional through hyd-  
 raulic cylinder up to  $\pm 30^\circ$  or through pinion rack  
 Tank openings: 27.6 x 27.6 in (Plate 38.6 in)  
 31.5 x 31.5 in (Plate 47.3 in)  
 39.4 x 39.4 in (Plate 56.3 in)

### Ex-Zone

Ex-zone 2 (outside tank) and zone 1 (inside tank)  
 Special system FR with 18 hp for Zone 1 (outside)  
 Classification mechanical components  
 II 2G ck IIA T3

### Control switch (optional)

Star-delta-switch (max. 20 hp), soft start or  
 frequency converter  
 Delivery without connection cable



## GIANTMIX FR SP

FR1 75-240

FR3 110-330

FR4 150-330

FR4 150-480

FR5 185-480

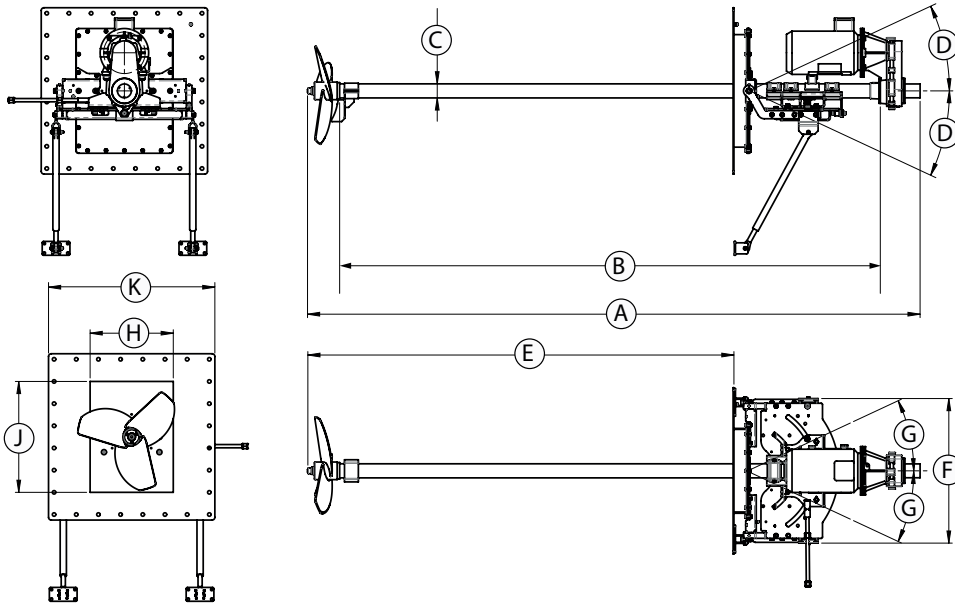

### Dimensions

Type	A [∅ in in]	B [in]	C [in]	D	E [in]	F [in]	G	H [in]	J [in]	K [in]
FR4 / FR5	138 / 177	114 / 154	4	max. ± 30°	83 / 122	43	± 25°	24	24	38.6
FR1 / FR3 / FR4 (330 rpm)									32	47.2

### Technical data

Type	Rated Power [hp]	Propeller speed [rpm]	Frequency [Hz]	Gear reduction ratio	Propeller diameter [in]	Axial force [lbf]	Flow velocity [ft/s] *	Pumping rate Water [gal/min]	Weight approximate [lbs]
FR1	10.0	240	60	3.69	31.5	449	6.9	22,718	1,433
FR3	15.0	330	60	5.31	26.0	517	10.8	16,642	1,433
FR4	20.0	330	60	5.31	29.5	696	12.1	24,832	1,433
FR4	20.0	480	60	3.69	21.3	606	13.8	14,529	1,433
FR5	25.0	480	60	3.69	22.8	719	13.5	16,378	1,433

Subject to technical changes

\* measured in water and 3.94 distance

As per: 2018-07

© SUMA America Inc. | 2700 Patriot Blvd Suite 250 | Glenview, IL 60026

Tel: (312) 945 9049 | E-mail: sales@gosuma.com | www.gosuma.com